

	A	B	C	D	E	F	G	H
1	G1	RX	B4s	B4w	B1w	B1s	B2s	B2w
2	G2	TX	Tgas	Tred	GND_panel	IGNITION	GND BAT	B3w
3	G3	-	V	P	data_panel	RPM	Valve	B3s
4	G4	-	+5V	-	12V_panel	Gas_Level	+12VG	+12V BAT

! El controlador es incompatible con el arnés JET OBD MINI.
The JET ECO gas controller is incompatible with the JET OBD MINI harness.

DIAGRAMA DE CONEXIÓN TECHNICAL DIAGRAM



ver. 08.11.2023

max. 4 cyl.

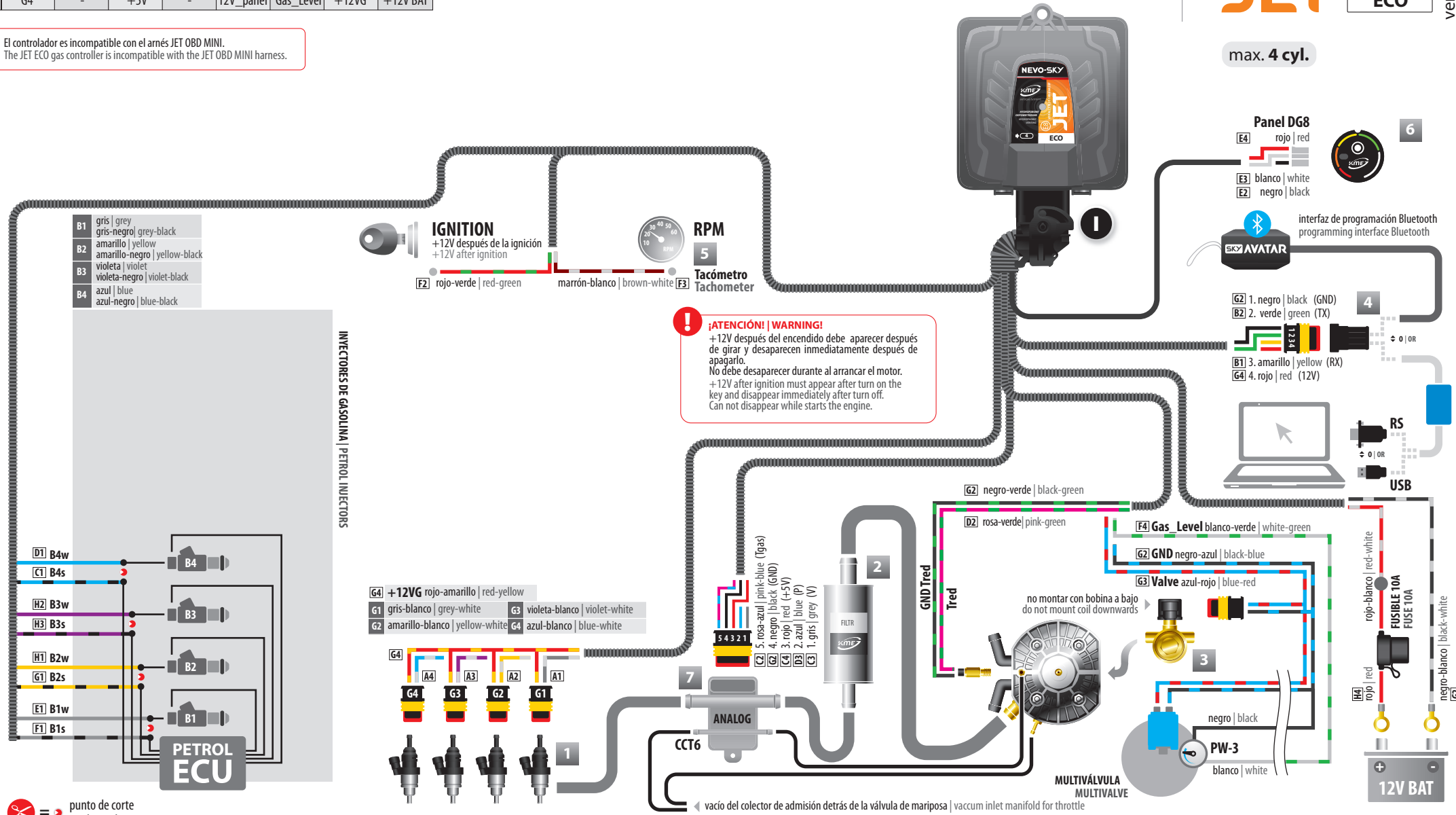

! ¡ATENCIÓN! WARNING!
+12V después del encendido debe aparecer después de girar y desaparecer inmediatamente después de apagarlo.
+12V after ignition must appear after turn on the key and disappear immediately after turn off.
Can not disappear while starts the engine.

INYECTORES DE GASOLINA | PETROL INJECTORS

B1	gris grey
	gris-negro grey-black
B2	amarillo yellow
	amarillo-negro yellow-black
B3	violeta violet
	violeta-negro violet-black
B4	azul blue
	azul-negro blue-black

G4	+12VG rojo-amarillo red-yellow	G3	violeta-blanco violet-white
G1	gris-blanco grey-white	G2	azul-blanco blue-white
G2	amarillo-blanco yellow-white		

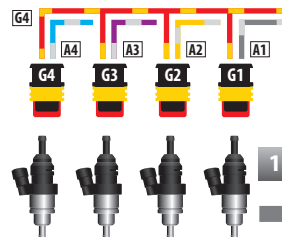

- 1** inyectores de gas
gas injectors
- 2** filtro de gas
gas filter
- 3** multivalvula de gas
electrovalve
- 4** interfaz de programación | RS232 | USB | Bluetooth
programming interface | RS232 | USB | Bluetooth
- 5** RPM | módulo de encendido | tacómetro
sensor de Hall | árbol de levas
RPM | ignition module | tachometer
Hall sensor | camshaft sensor
- 6** panel de conductor
control panel
- DG4** **DG5** **DG7** **DG8**
- 7** sensor de presión
pressure sensor
- no montar de conector arriba
do not mount connector upwards

= punto de corte
cutting point

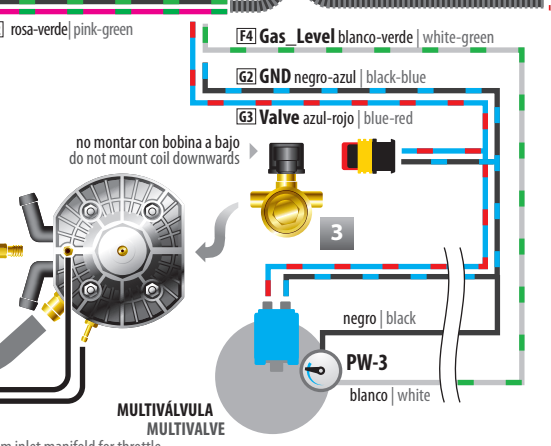
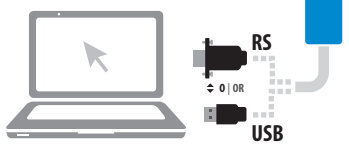
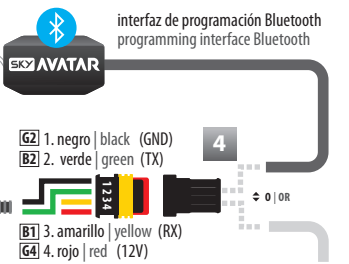
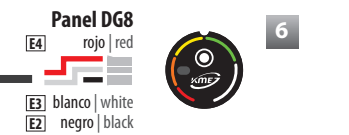
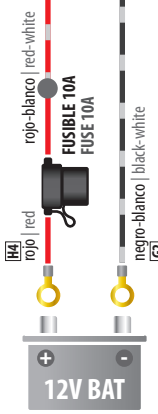

	A	B	C	D	E	F	G	H
1	G1	RX	B4s	B4w	B1w	B1s	B2s	B2w
2	G2	TX	Tgas	Tred	GND_panel	IGNITION	GND BAT	B3w
3	G3	GND_int	V	P	data_panel	RPM	Valve	B3s
4	G4	+12V_int	+5V	GND	12V_panel	Gas_Level	+12VG	+12V BAT

! El controlador es incompatible con el arnés JET OBD MINI.
The JET ECO gas controller is incompatible with the JET OBD MINI harness.

DIAGRAMA DE CONEXIÓN TECHNICAL DIAGRAM



ver. 08.11.2023

max. 4 cyl.

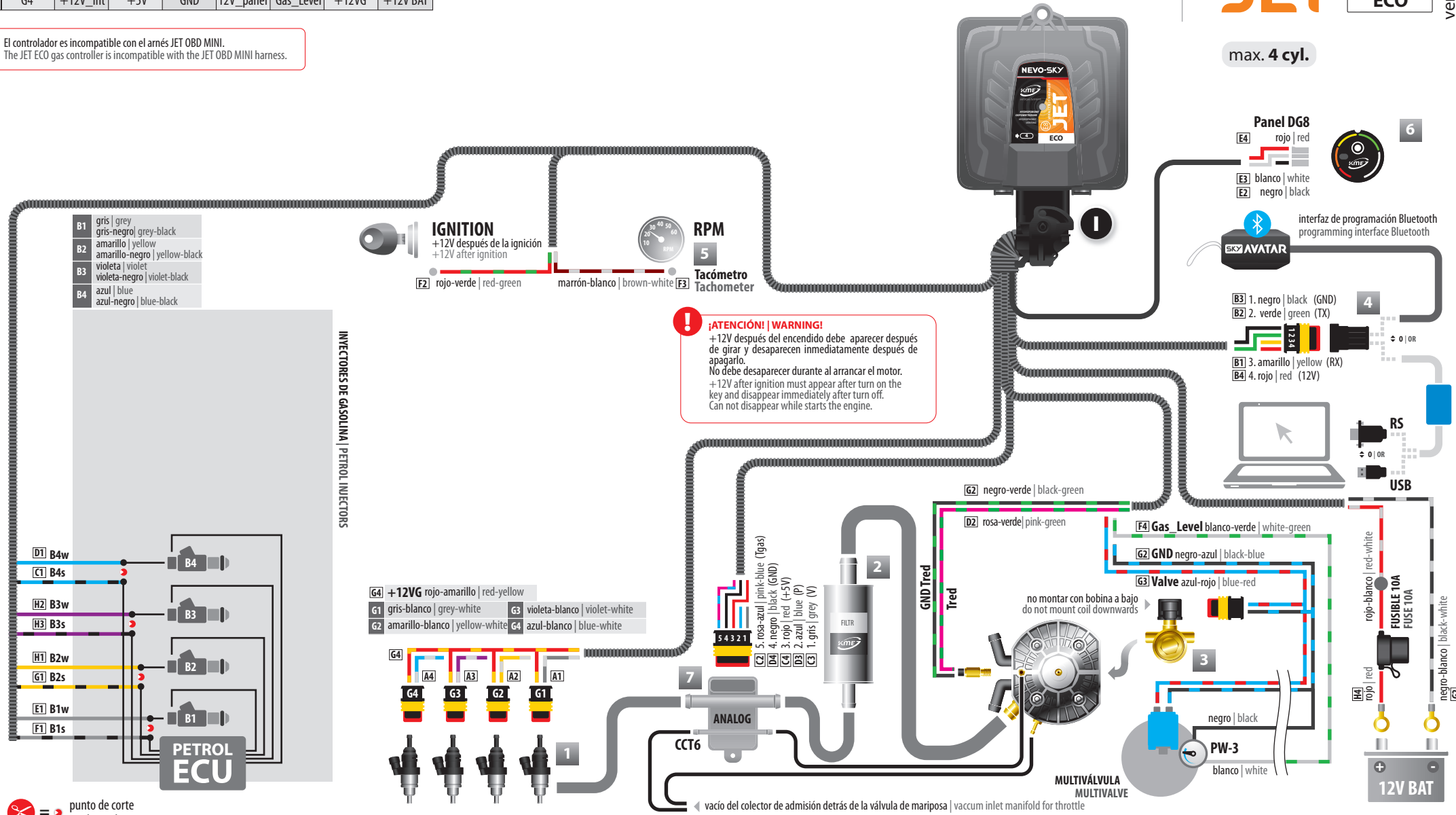

= punto de corte
cutting point

- 1 inyectores de gas
gas injectors
 - 2 filtro de gas
gas filter
 - 3 multivalva de gas
electrovalve
 - 4 interfaz de programación | RS232 | USB | Bluetooth
programming interface | RS232 | USB | Bluetooth
 - 5 RPM | módulo de encendido | tacómetro
sensor de Hall | árbol de levas
RPM | ignition module | tachometer
Hall sensor | camshaft sensor
 - 6 panel de conductor
control panel
 - 7 sensor de presión
pressure sensor
- DG4** **DG5** **DG7** **DG8**
- no montar de conector arriba
do not mount connector upwards**
- no montar de conector arriba
do not mount connector upwards**